



# MVE 1200/3

Three Phases - 2 poles - 3000 RPM - 50 Hz  
230/400 Volt



Mechanical Features		Electric Features	
<b>General</b>		<b>General</b>	
Working Moment	<b>20.26</b> kgcm	Nominal Voltage	<b>Δ : 230 V    Y : 400 V</b>
Unbalance	<b>10.13</b> kgcm	Input Power	<b>0.95</b> kW
FC	<b>1005</b> kg	Current A Max	<b>Δ : 3.22 A    Y : 1.85 A</b>
<b>Bearings</b>		Power factor	<b>0.82</b>
TYPE (SKF)	<b>6306 2Z</b>	Ia/In	<b>4,4</b>
	100% <b>549</b>	<b>Certification</b>	
Life(h)	80%: <b>1073</b>	ETL CLASS II DIV.II GROUP F,G TENV NEMA 4	<b>T4</b>
	50%: <b>4393</b>	ATEX II 3D Ex tc IIIC Tx IP66	<b>T 100°</b>
<b>Bearing Grease</b>		Amb Temp.	<b>-20 ≤ T°C ≤ + 40</b>
Lube Schedule (g)			
Lube Replacement (g)			
Grease Type			

## Dimensional Features (mm)

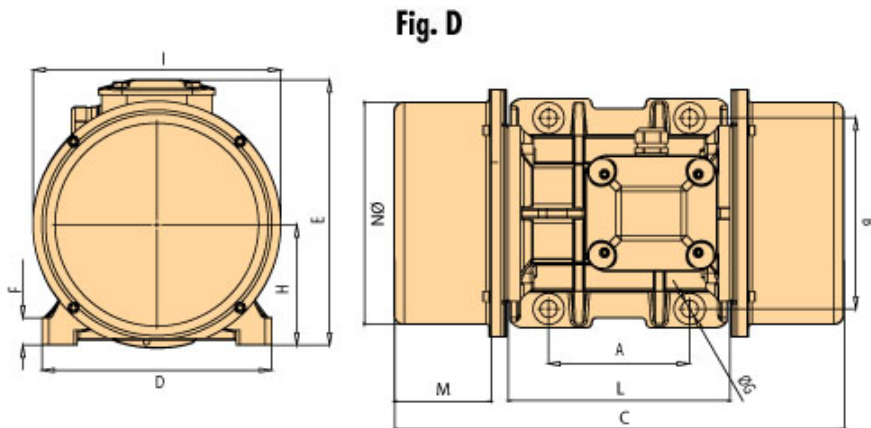

A	<b>120</b>
B	<b>170</b>
C	<b>321</b>
M	<b>58</b>
G	<b>17</b>
holes	<b>4</b>
D	<b>208</b>
E	<b>210</b>
F	<b>22</b>
H	<b>94</b>
I	<b>180</b>
L	<b>205</b>
N	<b>170</b>

Clamping  
Torque(Nm)

**185**

[ [Drawings Download](#) ]

Weight(kg)	Screw	Washer	Cable Type	Cable Glандe
<b>21.6</b>	<b>M16</b>	<b>17x30</b>	<b>4Gx2.5</b>	<b>M20x1,5</b>

REV.2-03/13/2013