



# MVE 50 DC 12

Single Phase - poles - 3000 RPM - 0 Hz  
12 Volt



Mechanical Features		Electric Features	
<b>General</b>		<b>General</b>	
Working Moment	<b>1.02 kgcm</b>	Nominal Voltage	$\Delta$ : <b>12</b>
Unbalance	<b>0.51 kgcm</b>	Input Power	<b>0.08 kW</b>
FC	<b>50 kg</b>	Current A Max	$\Delta$ : <b>6.6 A</b>
<b>Bearings</b>		Power factor	<b>0</b>
TYPE (SKF)	<b>6202 2Z</b>	Ia/In	<b>4</b>
	100% <b>39026</b>	<b>Certification</b>	
Life(h)	80%: <b>76223</b>	ATEX II 3D Ex tc IIIC Tx IP66	<b>T 100°</b>
	50%: <b>&gt;100000</b>	Amb Temp.	<b>-20 ≤ T°C ≤ + 40</b>
<b>Bearing Grease</b>			
Lube Schedule (g)			
Lube Replacement (g)			
Grease Type			

## Dimensional Features (mm)

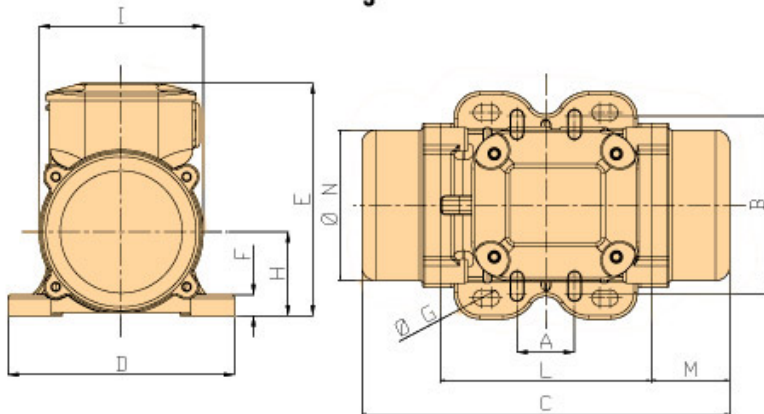

A	<b>62-74 33</b>
B	<b>106 82- 102</b>
C	<b>211</b>
M	<b>45</b>
G	<b>9 7</b>
holes	<b>4 4</b>
D	<b>130</b>
E	<b>136</b>
F	<b>12</b>
H	<b>48</b>
I	<b>94</b>
L	<b>121</b>
N	<b>85</b>

Clamping  
Torque(Nm)

**23  
9**

[ [Drawings Download](#) ]

Weight(kg)	Screw	Washer	Cable Type	Cable Glандe
<b>4.4</b>	<b>M8 M6</b>	<b>8.4 x 16 6.4 x 12</b>	<b>2Gx1.5</b>	<b>M16x1,5</b>

REV.3-20/10/2016

