



MVE 50 DC 24

Single Phase - poles - 3000 RPM - 0 Hz
24 Volt



Mechanical Features		Electric Features	
General		General	
Working Moment	1.02 kgcm	Nominal Voltage	Δ : 24
Unbalance	0.51 kgcm	Input Power	0.08 kW
FC	50 kg	Current A Max	Δ : 3.3 A
Bearings		Power factor	0
TYPE (SKF)	6202 2Z	Ia/In	4
	100% 39026	Certification	
Life(h)	80%: 76223	ATEX II 3D Ex tc IIIC Tx IP66	T 100°
	50%: >100000	Amb Temp.	-20 ≤ T°C ≤ + 40
Bearing Grease			
Lube Schedule (g)			
Lube Replacement (g)			
Grease Type			

Dimensional Features (mm)

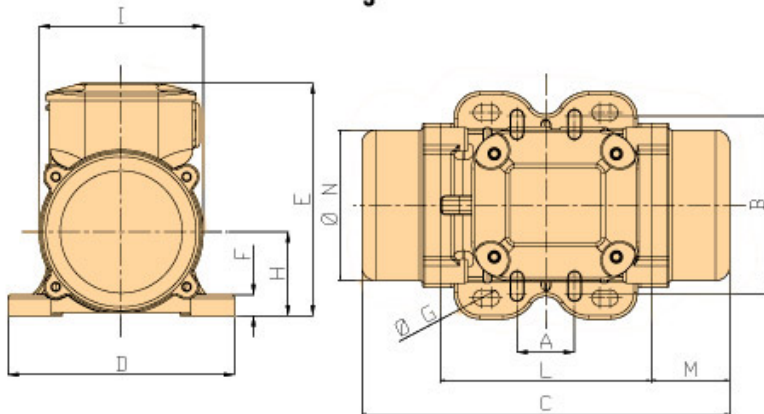

A	62-74 33
B	106 82- 102
C	211
M	45
G	9 7
holes	4 4
D	130
E	136
F	12
H	48
I	94
L	121
N	85

Clamping
Torque(Nm)

**23
9**

[[Drawings Download](#)]

Weight(kg)	Screw	Washer	Cable Type	Cable Glандe
4.4	M8 M6	8.4 x 16 6.4 x 12	2Gx1.5	M16x1,5

REV.3-20/10/2016

