

Mechanical Features		Electric Features	
<b>General</b>		<b>General</b>	
Working Moment	1.31 kgcm	Nominal Voltage	$\Delta$ : 230 V    Y : 400 V
Unbalance	0.66 kgcm	Input Power	0.08 kW
FC	66 kg	Current A Max	$\Delta$ : 0.28 A    Y : 0.16 A
<b>Bearings</b>		Power factor	0.74
TYPE (SKF)	6202 2Z	la/ln	3
	100% 39026	<b>Certification</b>	
Life(h)	80%: 76223	ETL CLASS II DIV.II GROUP F,G TENV NEMA 4	T4
	50%: >100000	ATEX II 3D Ex tc IIIC Tx IP66	T 100°
<b>Bearing Grease</b>		Amb Temp.	-20 ≤ T°C ≤ + 40
Lube Schedule (g)			
Lube Replacement (g)			
Grease Type			

### Dimensional Features (mm)

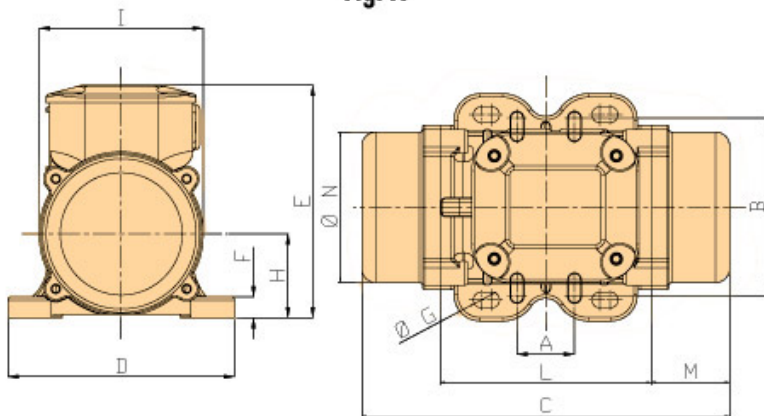

A	62-74 33
B	106 82- 102
C	211
M	45
G	9 7
holes	4 4
D	130
E	136
F	12
H	48
I	94
L	121
N	85

Clamping  
Torque(Nm)

23  
9

[ Drawings Download ]

Weight(kg)	Screw	Washer	Cable Type	Cable Glante
4.2	M8 M6	8.4 x 16 6.4 x 12	4Gx1.5	M16x1,5